

**ORDER FOR LOCATION OF TRAFFIC CABINET**

By the City Council of the City of Framingham, Massachusetts notice having been given and a public hearing held, as provided by law, **IT IS HEREBY ORDERED that**

That permission be and hereby is granted to **NSTAR GAS COMPANY (EVERSOURCE ENERGY)** to install a new traffic cabinet within the layout of the public way during the replacement of the existing district regular vaults with associated inlet and outlet piping under the surface of the following public way or ways as requested in Petition of said company dated the 22<sup>nd</sup> day of July 2019.

MT. WAYTE AVENUE: To install a new traffic cabinet with associated inlet and outlet piping in front of #73 Mt. Wayte Avenue during the replacement of the existing regulator vaults.

Substantially as shown on plan marked – TAKE STATIONS AND DISTRICT REGULATORS – DISTRICT REGULATOR @ MT. AYTE AVEN, GRAMINGHAM MA – EXISTING CONDITIONS PLAN - #18-REG-219-02 Sheet 2 of 2, dated 7/12/19 showing location of traffic cabinet filed with said petition. Installation plans for the replacement facilities as well as for the retirement and abandonment of the existing vaults and proposed schedules for each were reviewed.

The foregoing permission is subject to the conditions set forth in a letter dated August 19, 2019 from the Framingham Department of Public Works as follows:

1. Based on subsequent communication with the Applicant, it is our understanding that the scope of this work is limited to the installation of the aboveground cabinet as submitted in the attached figure. The location of underground infrastructure will not change.
2. The Applicant shall obtain appropriate access rights to the abutter property.
3. Grant of Location approval does not include traffic management plan.
4. Construction shall be coordinated with City's Capital Projects on Union Avenue.
5. DPW requests notification prior to the start of work to verify final location in the field and that no public utilities are adversely affected.
6. The applicant shall obtain a Street Opening Permit and a Trench Opening Permit for this work.
7. The applicant shall submit a traffic management plan to DPW for review and approval prior to construction.
8. All work shall conform to the City of Framingham construction standards.

I hereby certify that the foregoing order was adopted at a meeting of the City Council of the City of Framingham, Massachusetts held on the **19<sup>th</sup> day of September, 2019.**

  
 \_\_\_\_\_  
 Lisa A. Ferguson  
 City Clerk

We hereby certify that on **September 19, 2019** at **7:15 PM** at Memorial Hall, 150 Concord Street, Framingham Massachusetts a public hearing was held on the petition of:

**NSTAR GAS COMPANY (EVERSOURCE ENERGY)**

for permission to install a new traffic cabinet with associated inlet and outlet piping in front of #73 Mt. Wayte Avenue during the replacement of the existing regulator vaults, described in the order herewith recorded, and that at least seven days before said hearing a written notice of the time and place of said hearing was mailed to each of the owners of real estate (as determined by the last preceding assessment for taxation) along the ways or parts of ways upon which the Company are permitted to install such a cabinet under said order.

And that there upon said order was duly adopted.

City Council  
City of Framingham, Massachusetts

**CERTIFICATE**

I hereby certify that the foregoing is a true copy of a location order and certificate of hearing with notice adopted by City Council of the City of Framingham, Massachusetts on the **19<sup>h</sup> day of September 2019** and recorded with the records of location orders of said City, Book 17, Page 19-9. This certified copy is made under the provisions of Chapter 166 of General Laws and any additions thereto or amendments thereof.

Attest:

  
\_\_\_\_\_  
Lisa A. Ferguson  
City Clerk



CITY OF FRAMINGHAM  
DEPARTMENT OF PUBLIC WORKS  
FRAMINGHAM, MASSACHUSETTS 01702

*"Dedicated to  
Excellence  
in Public  
Service"*

PETER A. SELLERS  
EXECUTIVE DIRECTOR | FDPW  
BLAKE D. LUKIS  
DEPUTY DIRECTOR | FDPW  
WILLIAM R. SEDEWITZ - PE  
CHIEF ENGINEER | FDPW  
DIANE M. CONNER  
ASSISTANT DIRECTOR | FDPW

August 19, 2019

City Council  
City of Framingham  
Memorial Building  
150 Concord Street  
Framingham, MA 01702

Re: Traffic Cabinet - Grant of Location Request – 73 Mt. Wayte Avenue

Dear City Council Members,

The Department of Public Works (DPW) is in receipt of a request from NSTAR Gas Company to locate a Traffic Cabinet within the layout of the public way as represented under submitted Grant of Location application package dated July 22, 2019. The traffic cabinet shall be owned and maintain by the Petitioner.

We have reviewed this Grant of Location request submitted to the City Council and recommend approval subject to the following conditions:

1. Based on subsequent communication with the Applicant, it is our understanding that the scope of this work is limited to the installation of the aboveground cabinet as submitted in the attached figure. The location of underground infrastructure will not change.
2. The applicant shall obtain appropriate access rights to the abutter property.
3. Grant of Location approval does not include traffic management plan.
4. Construction shall be coordinated with City's Capital Projects on Union Avenue.
5. DPW requests notification prior to the start of work to verify final location in the field and that no public utilities are adversely affected.
6. The applicant shall obtain a Street Opening Permit and a Trench Opening Permit for this work.
7. The applicant shall submit a traffic management plan to DPW for review and approval prior to construction.
8. All work shall conform to the City of Framingham construction standards.

Please contact me at (508) 532-6010 if you have any questions.

Yours very truly,

Eric V. Johnson, P.E.  
City Engineer

Enclosure(s)

CC: Peter Sellers, Executive Director FDPW  
William R. Sedewitz, P.E., Chief Engineer

Dan Nau, Highway & Sanitation Director  
Jeanette M. Galliardt, License Administrator



LOCUS MAP

LEGEND

Proposed Line	Proposed Line
Major Collector	Major Collector
Minor Collector	Minor Collector
Collector	Collector
Service Line	Service Line
Sanitary Sewer	Sanitary Sewer
Storm Sewer	Storm Sewer
Water Main	Water Main
Gas Main	Gas Main
Electric Line	Electric Line
Telephone Line	Telephone Line
Optical Fiber	Optical Fiber
Underground Cable	Underground Cable
Underground Telecommunications Line	Underground Telecommunications Line
Landfill (Old Building) Telecommunications Line	Landfill (Old Building) Telecommunications Line
Water Line	Water Line
Gas Line	Gas Line
Electric Line	Electric Line
Telephone Line	Telephone Line
Optical Fiber	Optical Fiber
Underground Utility - Spot Unknown	Underground Utility - Spot Unknown

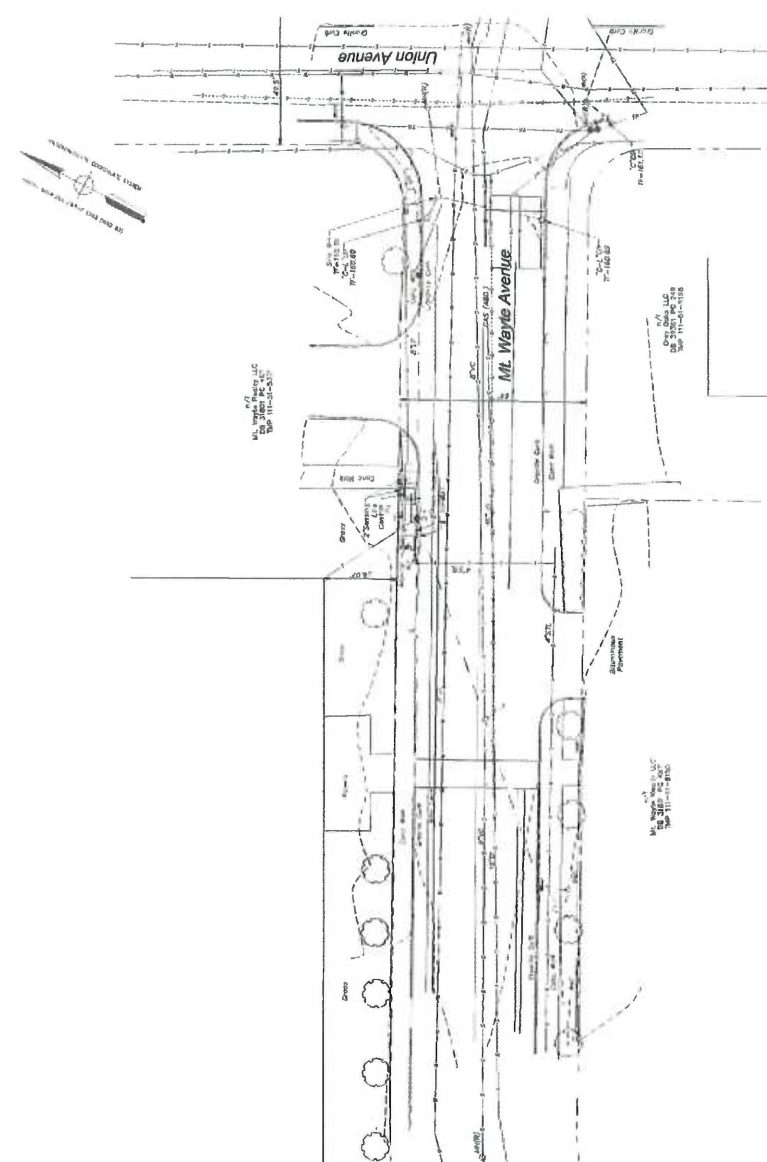

CONSTRUCTION SEQUENCE FOR MT. WAYTE AVE IN FRAMMINGHAM

- SET NEW VALVES AND COMPLETE THE INSTALLATION OF REGULATOR STATION PIPING BETWEEN THE INLET AND OUTLET CRITICAL VALVES AND TRAFFIC CABINET.
- INSTALL NEW 8" DIA. 150 LB. STEEL PIPE FROM THE 4" INLET CRITICAL VALVE TO THE 4" TAPPING VALVE.
- INSTALL NEW 4" DIA. 150 LB. STEEL PIPE FROM THE 4" TAPPING VALVE TO THE 4" TAPPING VALVE.
- PRESSURE TEST PIPING FROM THE 4" TAPPING VALVE TO THE 4" TAPPING VALVE. PRESSURE TEST IS 50 PSIG FOR 1 HOUR.
- CLOSE NEW 4" INLET VALVE. TAP 4" TAPPING VALVE ON THE IP MAIN AND PURGE UP TO THE VALVE THROUGH THE TAPPING MACHINE.
- PRESSURE TEST LP TIE IN PIECE. PRESSURE TEST IS 80 PSIG FOR 1 HOUR.
- INSTALL 8" MAX END CAP ON THE EXISTING 6" LP GAS MAIN WITH A 6" ELECTROFUSION COUPLING WITH TIE IN VALVE CLOSED.
- IN THE NEW CONTROL REGULATOR VAULT, CLOSE THE FOUR 4" BLOCK VALVES AND SET A VENT STACK ON A WELDOLET ON THE 2" PILOT GAS HEADER IN THE VAULT.
- INSTALL NEW 4" DIA. 150 LB. STEEL PIPE FROM THE 4" TAPPING VALVE TO THE 4" TAPPING VALVE. PRESSURE TEST IS 50 PSIG FOR 1 HOUR.
- OPEN THE NEW 4" INLET VALVE AND PURGE UP TO INLET OF CONTROL REGULATOR VAULT AND THROUGH THE PILOT GAS HEADER.
- INJECT NITROGEN THROUGH TIE IN ON LP TIE IN PIECE COMPLETELY FILLING NEW 4" LP OUTLET PIPING.
- REMOVE TIE IN VALVE AND PURGE UP TO OUTLET OF CONTROL REGULATOR VAULT AND THROUGH THE PILOT GAS HEADER.
- CLOSE VALVE ON EXISTING 4" IP ST INLET PIPING. CUT OFF EXISTING INLET PIPING AND INSTALL 4" MAX END CAPS.
- PURGE EXISTING REGULATOR PITS OUT OF SERVICE PER PROCEDURE.

GENERAL NOTES

- NORTH ARROW BASED ON MA863.
- ELEVATIONS AND CONTOURS ARE BASED ON NAVD83.
- ALL INFORMATION AND EXISTING DRAWINGS, THE SURVEYOR MAKES NO GUARANTEES THAT THE UNDERGROUND UTILITIES SHOWN COMPRISE ALL SUCH UTILITIES IN THE AREA, EITHER IN SERVICE OR ABANDONED. THE SURVEYOR FURTHER DOES NOT WARRANT THAT THE INFORMATION IS ACCURATE AS POSSIBLE FROM INFORMATION AVAILABLE. WHEN THEY ARE LOCATED AS ACCURATELY AS POSSIBLE FROM INFORMATION AVAILABLE, THE CONTRACTOR SHALL CONFIRM THE LOCATION OF ALL UTILITIES PRIOR TO THE COMMENCEMENT OF EXCAVATION.



1	RE-ISSUED FOR CONSTRUCTION	07/12/19	LEBAJ/RB
0	ISSUED FOR CONSTRUCTION	07/15/19	DT/AC/MO
Revision/Status		Date	Drawn/Checked
<b>EVERSOURCE ENERGY</b>			
TAKE STATIONS AND DISTRICT REGULATORS			
DISTRICT REGULATOR @ MT. WAYTE AVE, FRAMMINGHAM, MA			
EXISTING CONDITIONS PLAN			
SCALE: 1"=10'		Sheet Number	SHEET 2 OF 22
BY: 07/11/19		Drawn/Checked	18-REG-219-02
BY: 07/11/19		Field Number	1

FIELD VERIFY DIMENSIONS PRIOR TO PIPE FABRICATION